

Model NRS C-509 (2½" - 12")
ANSI 125#

Danfoss Flomatic



FEATURES:

Sizes: □ 2 ½" □ 3" □ 4" □ 6" □ 8"
□ 10" □ 12"

Max. working water pressure 250 PSI (1723 kPa)
Max. working water temperature 140°F (60°C)
Hydrostatic test pressure 400 PSI (2758 kPa)
End connection ANSI/ASME B16.1
Opens Left turn

STANDARDS COMPLIANCE:

- AWWA Compliant C-509

MATERIALS:

Valve Body & Handwheel Covers Coating Ductile Iron ASTM A536 Gr 65-45-12
AWWA compliant C-550 & FDA Compliant
Wedge Ductile Iron ASTM A536 Gr 65-45-12
With EPDM coating
Elastomers EPDM FDA approved
Fasteners Zinc plated steel ASTM A307 Grade B & Bronze ASTM B62 CDA 836
Stem Bronze ASTM B584 CDA 862

APPLICATION:

Designed for installation on potable water lines, irrigation systems, waterworks connections and fire systems.

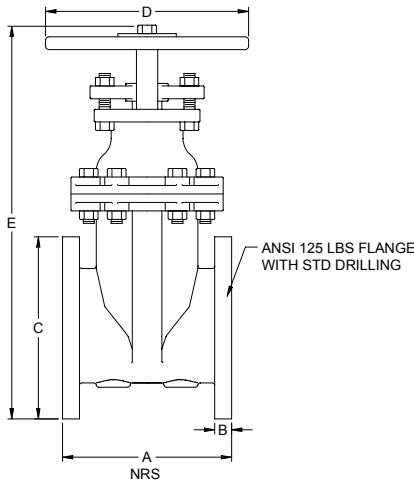

Size		Part #	A		B		C		D		E		WEIGHT	
Inch	mm		Inch	mm	Inch	mm	Inch	mm	Inch	mm	Inch	mm	lbs	kg
2-1/2	65	8461	7-1/2	191	11/16	18	7	178	7-1/4	184	14-7/8	378	38	17.2
3	80	8462	8	203	3/4	19	7-1/2	191	10	254	16-1/8	410	56	25.4
4	100	8463	9	229	15/16	24	9	229	10	254	19-1/4	489	78	35.4
6	150	8464	10-1/2	267	1	25	11	279	12	305	24-1/2	622	138	62.75
8	200	8465	11-1/2	292	1-1/8	29	13-1/2	343	14	356	29-1/4	743	214	97.25
10	250	8466	13	330	1-3/16	30	16	406	18	457	34-1/2	876	360	163.5
12	300	8467	14	356	1-1/4	6	19	483	18	457	39-1/2	1003	531	241

WARRANTY: Danfoss Flomatic valves are guaranteed against defects of materials or workmanship when used for the services recommended. If in any recommended service, a defect develops due to material or workmanship, and the device is returned, freight prepaid, to Danfoss Flomatic within 12 months from the date of purchase, it will be repaired or replaced free of charge. Danfoss Flomatics' liability shall be limited to our agreement to repair or replace the valve only.